

Kings Somborne Infiltration Plan

Appendix A – Status of Planned Actions July 2024



Summary of work completed

Work type	km
Length of sewer surveyed	13.13
Sewer Length Sealed	2.05
Sewers with no work required	9.56
Sewer sealing required	1.52
Manholes Sealed No.	5
Planned Manhole Sealing No.	2

Year	Surveyed (km)	Sewers sealed (km)	Manholes sealed
Pre 2014	5.53	0.15	0
2014	1.1	0	0
2015	1.1	1.2	4
2016	0.3	0.6	1
2017	0	0	0
2018	0	0	0
2019	0	0	0
2020	0	0	0
2021	0	0.1	0
2022	5.1	0	0
2023	0	0	0
2024	0	0	0
Post 2024	0	1.52	0

Note – Kings Somborne is not a village that suffers infiltration and sewerage issues annually. The priority for sewer sealing work is lower than other systems which do suffer more frequently. This is reflected in the reduction in planned work after 2018 following completion of the most significant sealing work.



Reference Plan

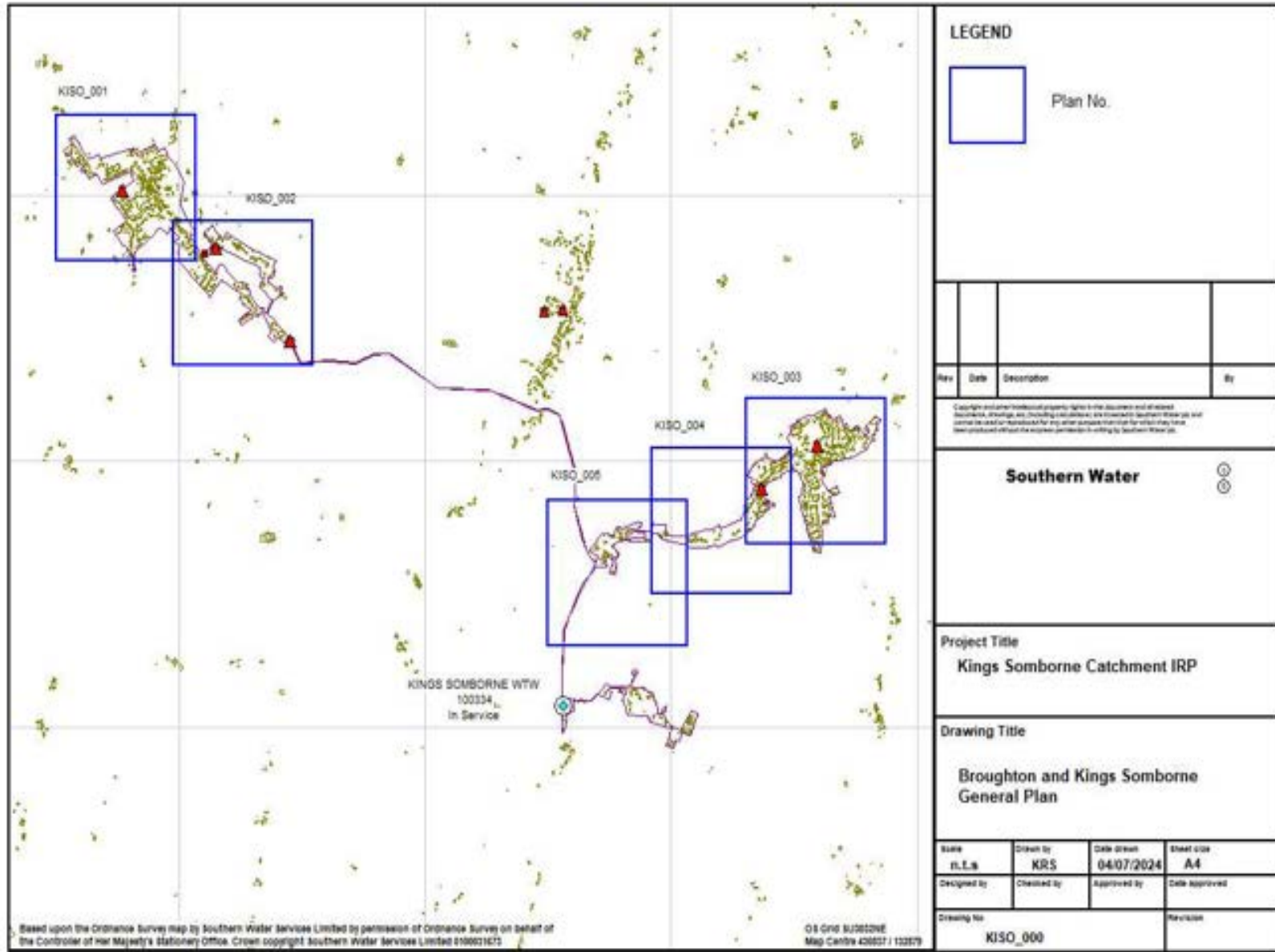

LEGEND



Rev	Date	Description	By

Copyright and other intellectual property rights in the documents and all related documents, drawings, etc. (including all drawings) are reserved by Southern Water and cannot be used for reproduction for any other purpose without the express written consent of Southern Water.

Southern Water



Project Title
Kings Somborne Catchment IRP

Drawing Title
**Broughton and Kings Somborne
General Plan**

Scale 1:1.5	Drawn by KRS	Date drawn 04/07/2024	Sheet size A4
Designed by	Checked by	Approved by	Date approved
Drawing No. KISO_000			Revision



Detailed plan 5

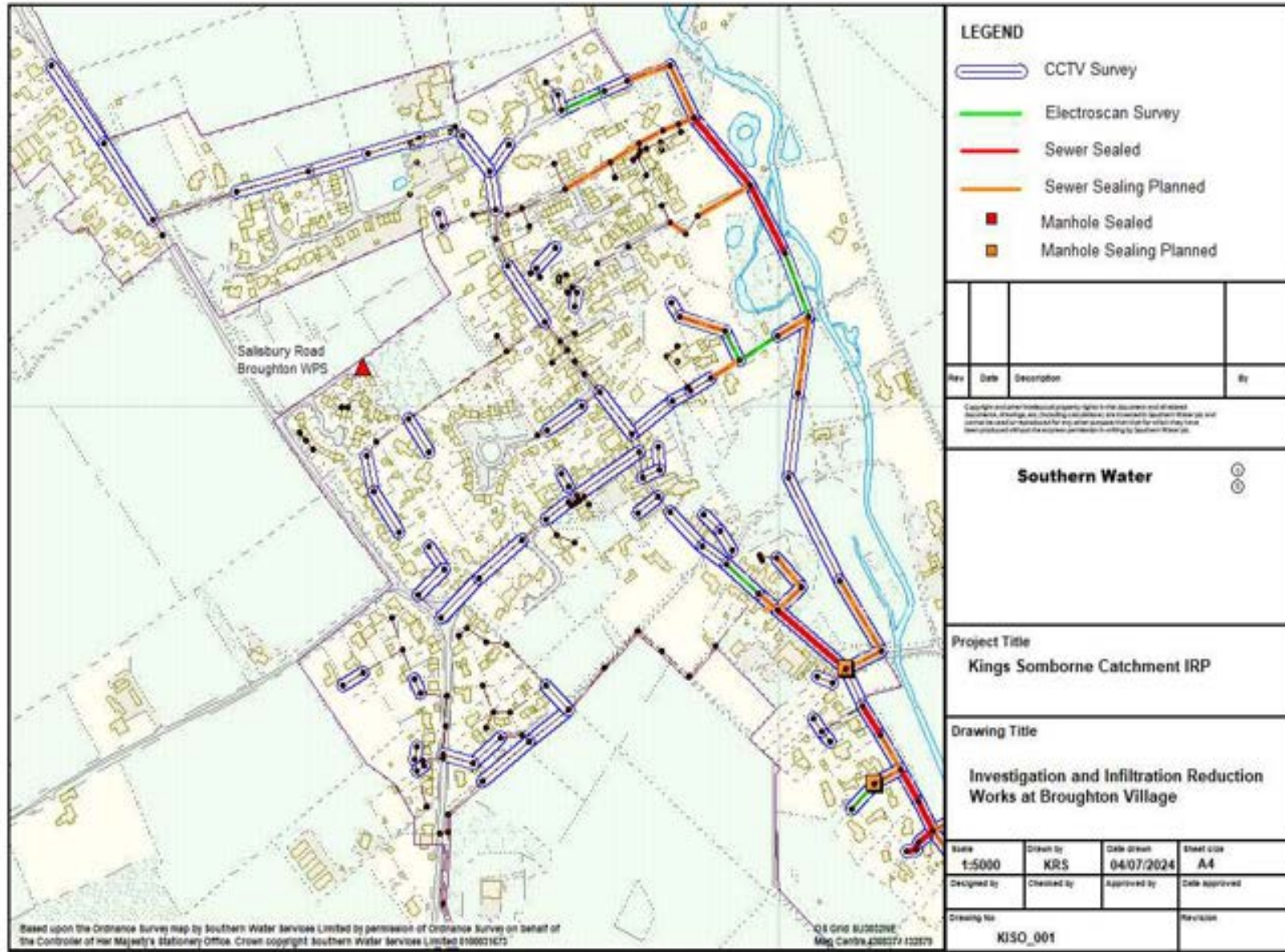

Note – sewers shown as surveyed by cctv or electroscan with no corresponding sealing work have been determined to not require rehabilitation.

LEGEND

- CCTV Survey
- Electroscan Survey
- Sewer Sealed
- Sewer Sealing Planned
- Manhole Sealed
- Manhole Sealing Planned

Rev	Date	Description	By

Copyright and other intellectual property rights in this document and all related documents, drawings, etc. (including variations) are reserved to Southern Water and cannot be used or reproduced for any other purpose without the express permission in writing by Southern Water plc.

Southern Water

Project Title
Kings Somborne Catchment IRP

Drawing Title
Investigation and Infiltration Reduction Works at Broughton Village

Scale 1:5000	Drawn by KRS	Date drawn 04/07/2024	Sheet size A4
Designed by	Checked by	Approved by	Date approved
Drawing No. KISO_001			Revision



Based upon the Ordnance Survey map by Southern Water Services Limited by permission of Ordnance Survey on behalf of the Controller of Her Majesty's Stationary Office. Crown copyright Southern Water Services Limited 01000216175

OS Grid BU50229E
Mag Cont'n 4200227 122079

Detailed plan 6

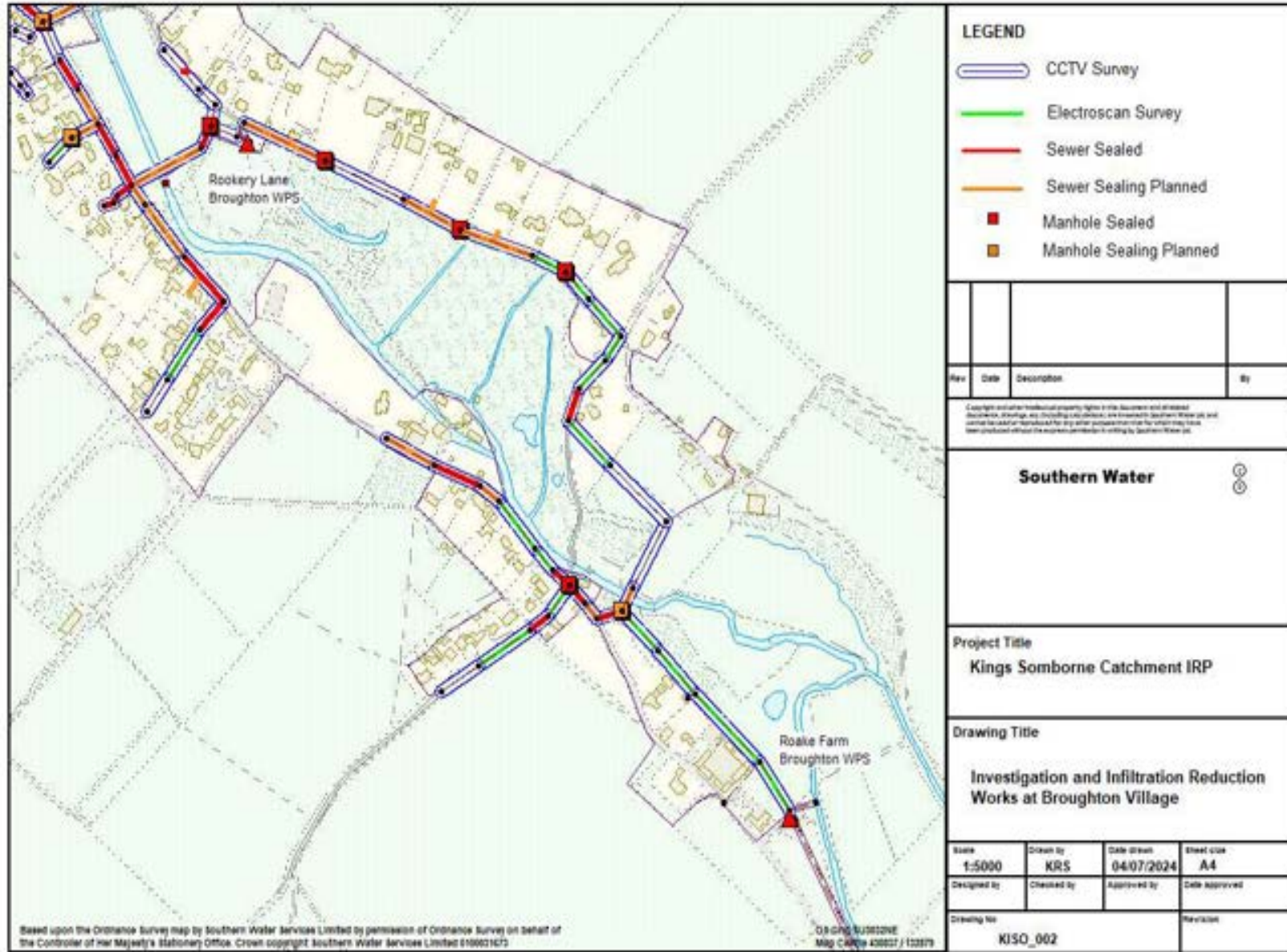

Note – sewers shown as surveyed by cctv or electroscan with no corresponding sealing work have been determined to not require rehabilitation.



Detailed plan 8

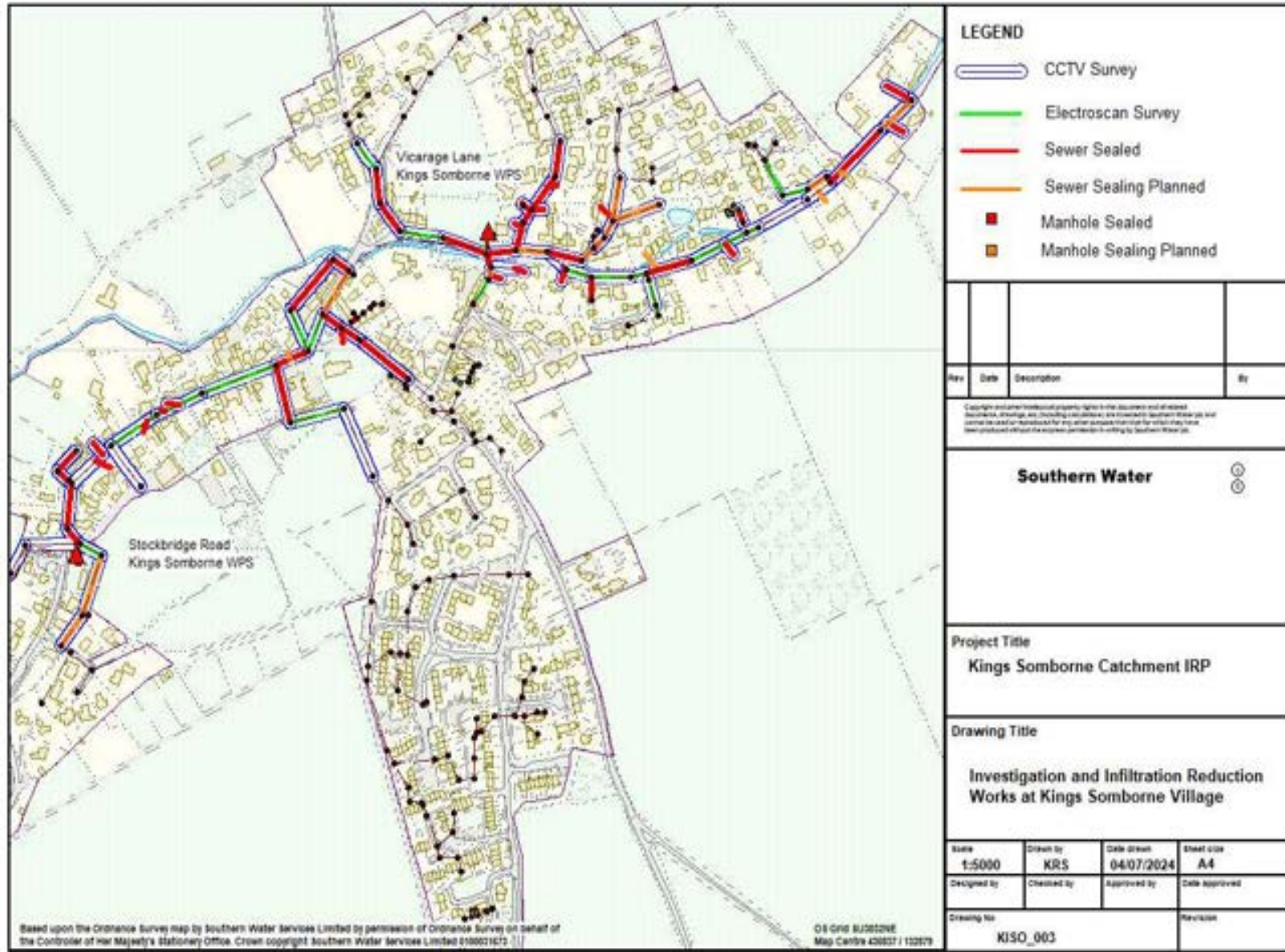

Note – sewers shown as surveyed by cctv or electroscan with no corresponding sealing work have been determined to not require rehabilitation.



Detailed plan 9

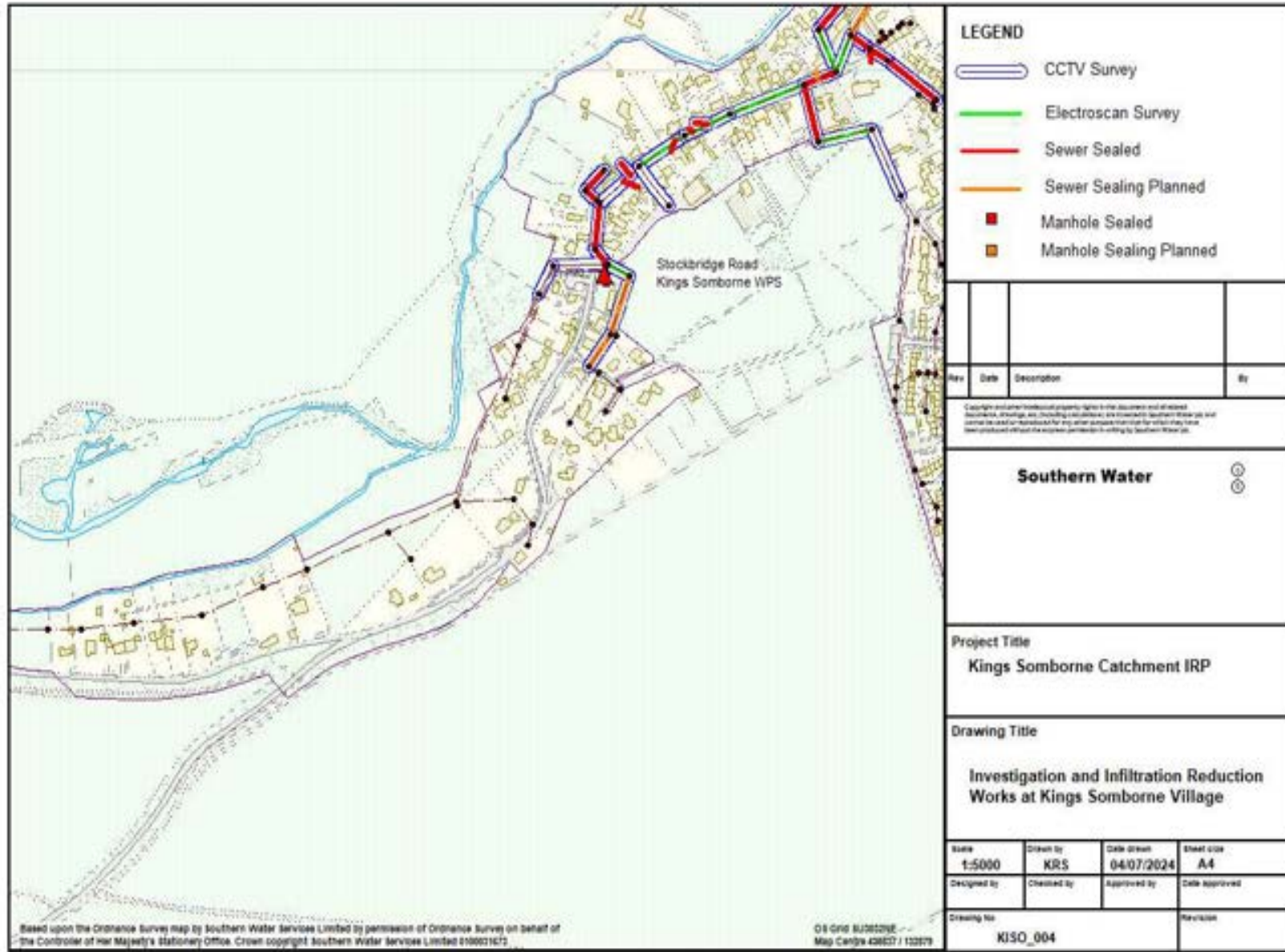

Note – sewers shown as surveyed by cctv or electroscan with no corresponding sealing work have been determined to not require rehabilitation.



Detailed plan 9

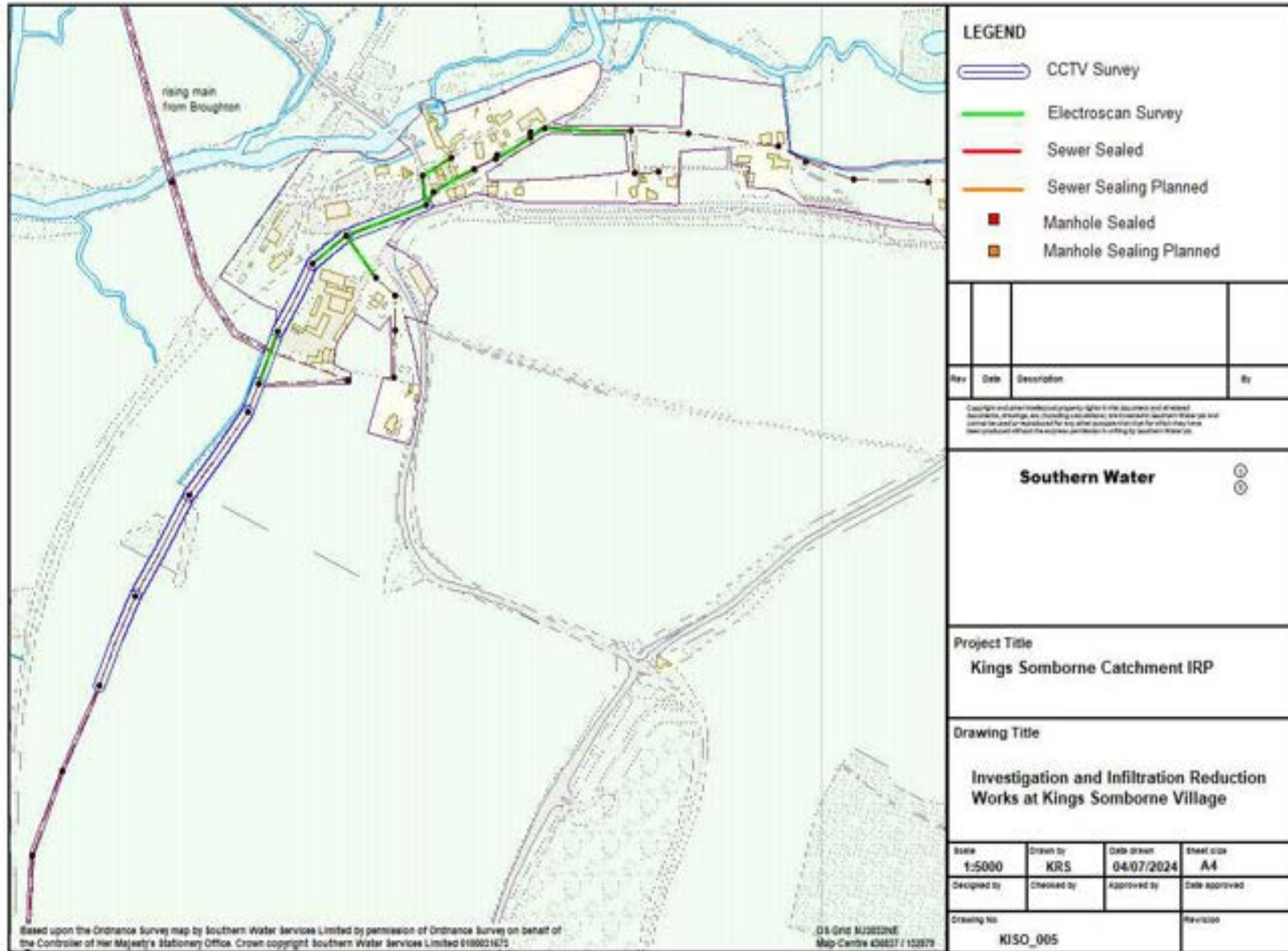

Note – sewers shown as surveyed by cctv or electroscan with no corresponding sealing work have been determined to not require rehabilitation.

